Meeting: Traffic Management Meeting
Date: 14th December 2010
Subject: Bedford Street, Ampthill - Resolution of an objection to the proposed Prohibition of Waiting
Report of: Basil Jackson, Assistant Director of Highways and Transportation.
Summary: To report to the Portfolio Holder for Safer and Stronger Communities the receipt of one objection to proposal for waiting restrictions in Bedford Street, Ampthill and seek approval for the implementation of this scheme.

Contact Officer: Ron Phelvin – Senior Technician Transportation Group
ron.phelvin@amey.co.uk
Public/Exempt: Public
Wards Affected: Ampthill
Function of: Council

CORPORATE IMPLICATIONS

Council Priorities:

To improve highway safety and facilitate the free flow of traffic.

Financial:

Implementation of this scheme will cost £2k and is available from existing budgets.

Legal:

None as part of this report

Risk Management:

None as part of this report

Staffing (including Trades Unions):

None as part of this report

Equalities/Human Rights:

None as part of this report

Community Safety:

The proposal will improve road safety

Sustainability:

None as part of this report

RECOMMENDATION(S):

1.

- (a) **That the proposal to introduce No Waiting At Any Time Restriction in Bedford Street, Ampthill be implemented as set out in this report.**

Background and Information

1. The Council has received complaints concerning parked vehicles in Bedford Street generally and specifically near to its junction with Swaffield Close. Most of the on-street parking appears to be associated with the adjacent Waitrose store.
2. These complaints were investigated and it was considered that a prohibition of waiting at any time should be introduced on the eastern side Bedford Street and at the junction of Swaffield Close. Keeping these areas clear of parked vehicle should resolve the aforementioned problems.
3. In advance of the statutory public notice stage, an informal consultation exercise was undertaken in August 2010. This was presented as part of a package of measures which also included waiting restrictions along Woburn Street. The main purpose being to determine local opinion on the proposals.
4. As a result of comments received during the initial consultation, the proposals were amended to incorporate a short length of double yellow lines at the entrance leading to the rear of nos.52-64 Bedford Street. Residents requested this in addition to the original proposals because parked cars were obstructing their access/egress.
5. A revised proposal was drawn up and this was formally advertised by public notice in September 2010. Consultations were also carried out with the emergency services and other statutory bodies, the Town Council and Elected Members. Residents were consulted again to give them a further opportunity to comment.
6. One objection was received from a resident on the West side of Bedford Road who was concerned with the lack of parking facilities in the area.
7. The objector states that she has lived at her property for 15 years and that there had been no problem with parking until the arrival of the Waitrose development. She also said that she couldn't understand the need for double yellow lines outside her property and that they were totally unnecessary. She further requested a residents only bay outside her property.
8. Bedfordshire Police accept the proposal and have raised no objections.

Conclusion and the Way Forward

9. In response to the objector's comments; it does appear that the parking in the area of the resident's home has increased as a result of the Waitrose development. The store has very little parking available for staff, so many of them park in Bedford Street.
10. Parked vehicles, particularly in the vicinity of the supermarket, create a hindrance to traffic flows in both directions along Bedford Street. The situation is exacerbated by parking at the junction of Swaffield Close and Bedford Street. The present level of parking obstructs visibility for drivers turning into and out of side roads and for crossing pedestrians. As a result, it is considered that the current parking creates a road safety hazard.
11. The provision of double yellow lines outside the objector's property is also considered necessary to promote road safety, particularly at the entrance to the rear of properties 52 to 64 Bedford Street. Irresponsible parking is preventing the safe manoeuvrability of vehicles entering or leaving the above properties.
12. It would be impractical to introduce a resident's permit scheme for just one or two parking spaces. These are usually implemented on a zonal basis, covering several streets.
13. In summary, the proposals are specifically intended to address obstructive parking in Bedford Street and visibility problems associated with the drivers emerging from Swaffield Close. Whilst the proposals will cause inconvenience to this particular resident, it is felt that the overall safety aspects will prove beneficial to the public as a whole. Consequently it is recommended the proposals for Bedford Road and Woburn Street are endorsed, and that the restrictions proceed as advertised.

Appendices:

Appendix A – Location plan

Appendix B – Public notice

Appendix C – Objection to proposal

APPENDIX A – LAYOUT PLANS BEDFORD STREET / WOBURN STREET.

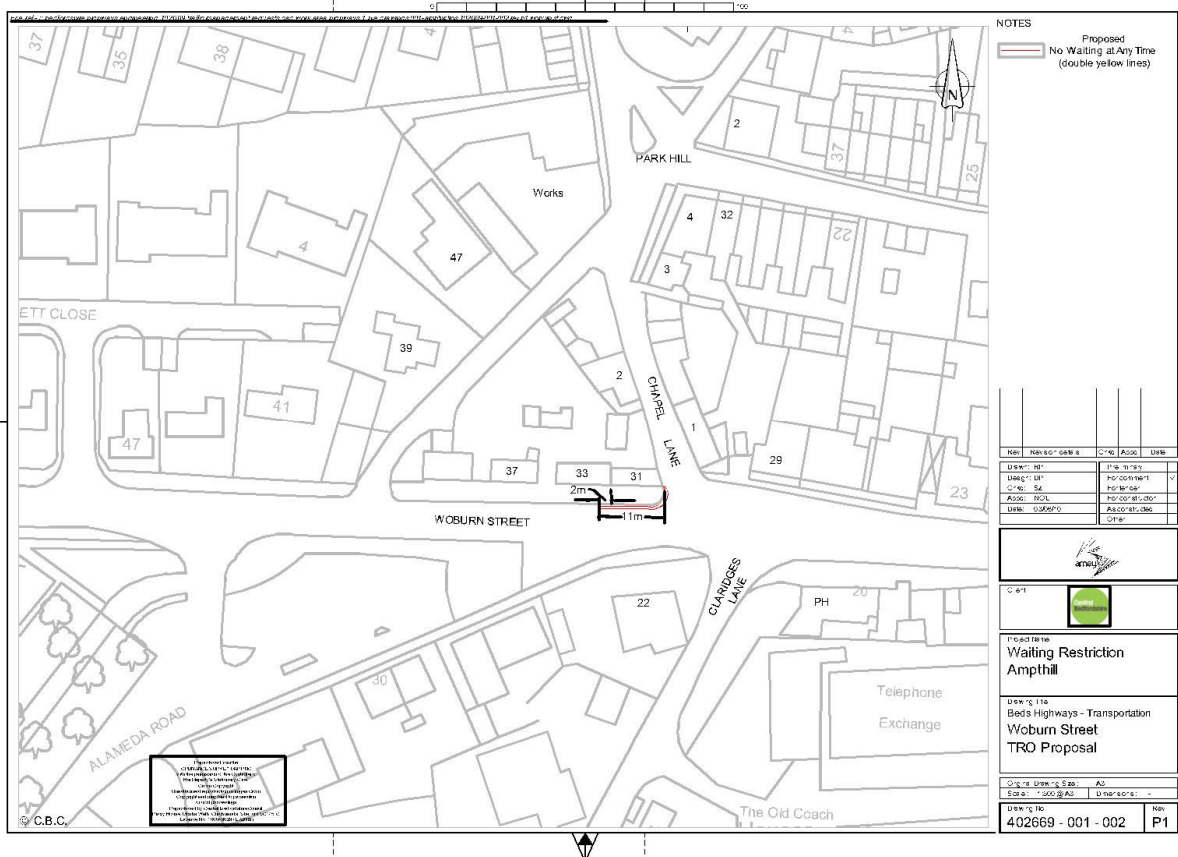
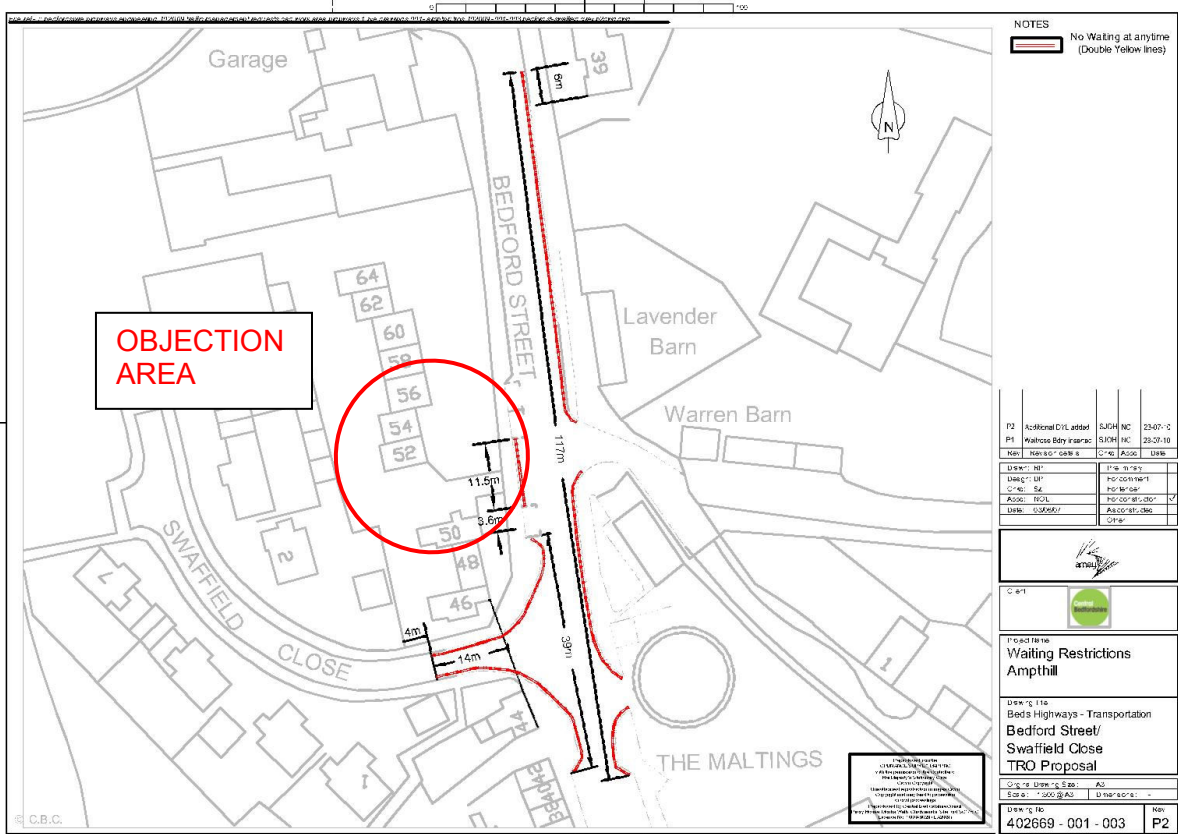

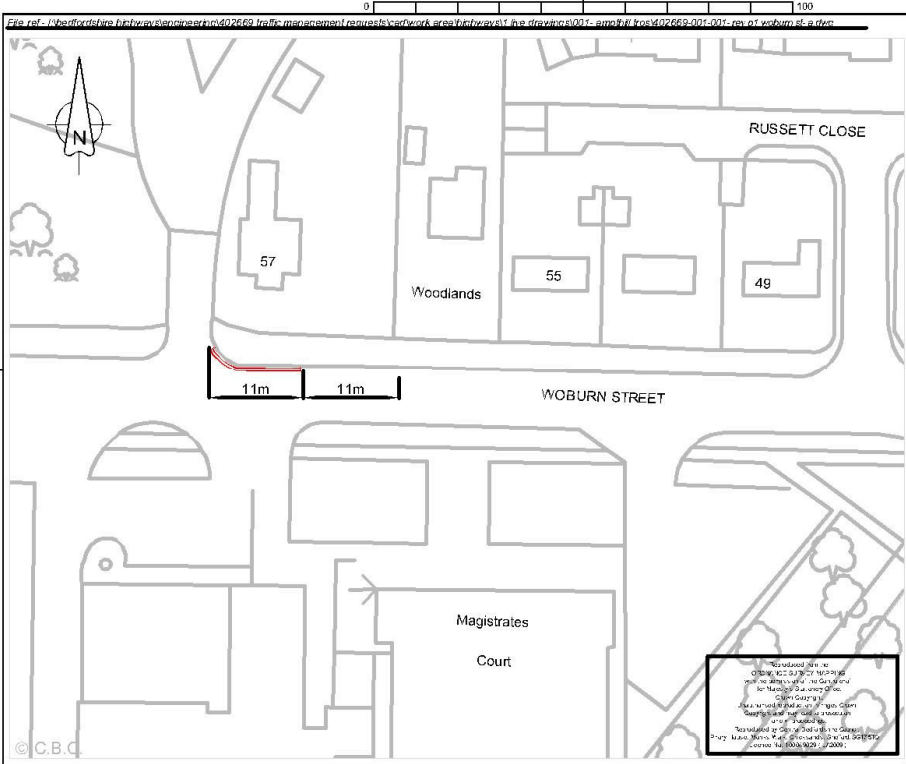

NOTES

 Proposed No Waiting at Any Time (double yellow lines)

P1	Dim's+Scale changed			6-8-10
Rev	Revision details	Chkd	Appd	Date
Drawn: RP				Preliminary
Design: DP				For comment
Checked: SJDH				For tender
App'd: N.O.L				For construction
Date: 03/08/10				As constructed
				For comment



Client

Project Name
**Waiting Restriction
 Ampthill**

Drawing Title
**Beds Highways - Transportation
 Woburn Street A
 TRO Proposal**

Original Drawing Size: A4
 Scale: 1:500
 Dimensions: m

Drawing No
402669 - 001-001

Rev
P1

Not valid for use
 outside the project
 area. This drawing is
 the property of
 C.B.C. and should
 not be reproduced
 without the written
 consent of C.B.C.

APPENDIX B

THIS NOTICE SUPERSEDES THE NOTICE PUBLISHED ON 27 SEPTEMBER
2009



Central
Bedfordshire

PUBLIC NOTICE

CENTRAL BEDFORDSHIRE COUNCIL PROPOSES TO INTRODUCE A NO WAITING RESTRICTIONS IN WOBURN STREET, BEDFORD STREET AND SWAFFIELD CLOSE AMPHILL.

Reason for proposal: Following complaints from residents the proposed Order is considered necessary to promote safety and the free flow of traffic, particularly at junctions.

Therefore, Central Bedfordshire Council proposes to make a Traffic Regulation Order as follows:

Effect of the Order:

To introduce No Waiting at Any Time (double yellow lines) on the following lengths of road in Ampthill:-

- Woburn Street on the north side from a point 11 metres west of the boundary between no. 57 Woburn Street and Woodlands westwards for approximately 11 metres.
- Woburn Street on the north side from a point 2 metres west of the boundary between nos. 31 and 33 Woburn Street eastwards for approximately 11 metres.
- Bedford Street on the west side from a point in line with the boundary between nos. 40 and 42 Bedford Street northwards to its junction with Swaffield Close.
- Bedford Street on the west side from its junction with Swaffield Close northwards to a point approximately 39 metres north of the boundary between nos. 40 and 42 Bedford Street.
- Bedford Street on the west side from a point approximately 3.6 metres north of the boundary between nos. 48 and 50 Bedford Street northwards for approximately 11.5 metres.
- Bedford Street on the east side from a point approximately 6 metres north of the south Flank wall of 39 Bedford Street southwards for a distance of approximately 117 metres.
- Swaffield Close on both sides from its junction with Bedford Street westwards to a point 4 metres east of the boundary between no. 2 Swaffield Close and no. 46 Bedford Street.

Further Details: of the proposed order and plans may be examined during normal office hours at the address below and normal opening hours at Ampthill Library, 1 Dunstable Street, Ampthill, MK45 2NL. These plans will be placed on deposit until 6 weeks after the Order is made or, until it is decided not to continue with the proposal. Phone Ron Phelvin on:-08453656009 for further details.

Objections: should be sent in writing to the Orders and Commons Registration Officer, Countryside Access Service, Central Bedfordshire Council, Technology House, 239 Ampthill

Road, Bedford MK42 9QQ, or (e-mail: chris.heard@centralbedfordshire.gov.uk) stating the grounds on which they are made by 29th October 2010.

Order Title: if made will be "Central Bedfordshire Council (Bedfordshire County Council) (District of Mid Bedfordshire) (Civil Enforcement Area and Special Enforcement Area) (Waiting Restrictions and Street Parking Places) (Consolidation) Order 2008) (Variation No *) Order 200*".

Technology House
239 Ampthill Road
Bedford MK42 9QQ

Basil Jackson
Assistant Director for Highways

7th October 2010

APPENDIX C

From: Xxxxx Xxxxx
Sent: 12 October 2010
To: Chris Heard – Countryside Access Service Forwarded to R. Phelvin 13-10-10
Cc: 'nick.chapman@amey.co.uk'
Subject: No Waiting Restriction – Bedford Street, Ampthill.

Dear Sirs

I have live at the above address for 15years, and until Waitrose came in there was no problem with parking in Bedford Street. Waitrose employ over a 100 people, all of whom have cars, bearing in mind the infrastructure of Ampthill, parking spaces are limited.

It is now being proposed to put double yellow lines outside my property, the reason for which I do not understand, and object to. This is the only place I can park since my cottage is mid terrace and I therefore feel these yellow lines are totally unnecessary. Number XX is set back from the road, and prior to the new layout near my property (totally wrong) there was never any congestion with traffic.

I will be writing to my M.P. and if necessary the Beds on Sunday, why could not the Bay outside my property be marked for “residents only”?

I would appreciate your comments

Yours faithfully.

X. Xxxxxx (mrs)

Bedford Street .
Ampthill.
